

Radial grippers HGRC

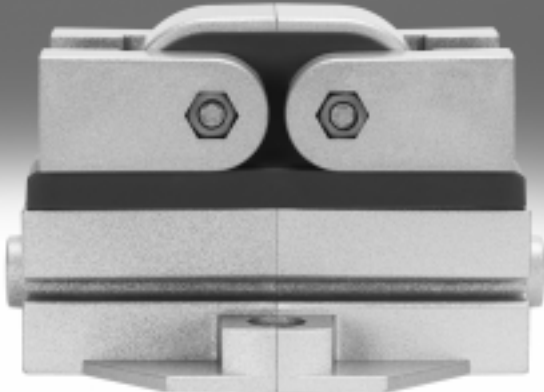

- 7 - Type discontinued  
Available up until 2018

FESTO

## Radial grippers HGRC

Key features

### At a glance

#### General information

The compact and cost-optimised radial gripper consists of a two-part mirror-symmetrical housing made of die-cast zinc. The force generated by the linear motion of the piston is translated into the gripper jaw movement via a pneumatic piston, which acts directly on the gripper jaws

installed in the housing by means of a moment compensator in accordance with the rack and pinion principle. To ensure a low-backlash plain-bearing guide for the gripper jaws, appropriate guide elements are fitted in the housing and pretensioned by means of socket head screws.

- Double-acting gripper
- Internal fixed flow control, does away with the need for external flow control in 90% of applications
- High force with minimal volume
- Suitable for external and internal gripping

- Opening angle of 180°
- Repetition accuracy of 0.05 mm
- Slot for proximity sensor SME/SMT-10
- Wide range of options for mounting on drives

- Note

Sizing software for gripper selection  
→ [www.festo.com](http://www.festo.com)

### Details

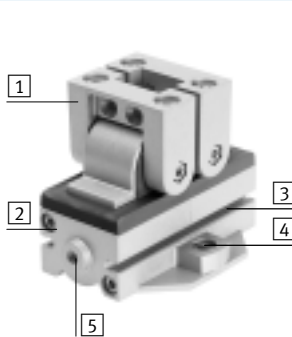

- 1 Gripper jaw
- 2 Housing based on half-shell principle
- 3 Slot for proximity sensor, for sensing the piston position
- 4 Mounting option
- 5 Supply port

### Mounting option from underneath

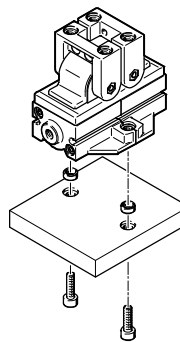

### from above

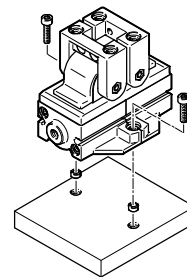

- Note

Radial grippers are not designed for the following sample applications:

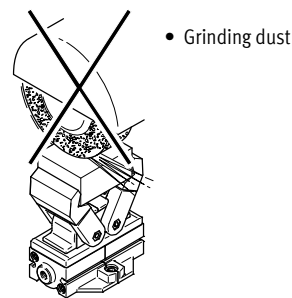
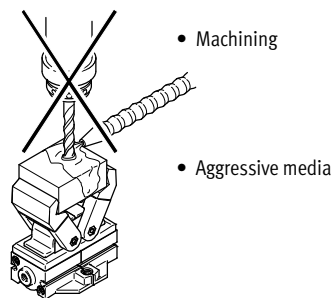

- Welding spatter

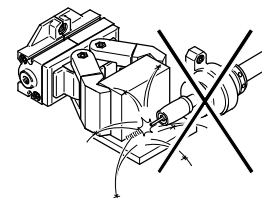

- 2 - Type discontinued  
Available up until 2018

FESTO

## Radial grippers HGRC

Peripherals overview and type codes

### Peripherals overview

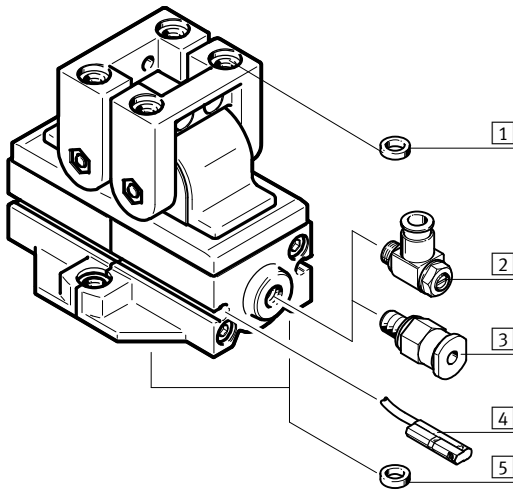

### System product for handling and assembly technology

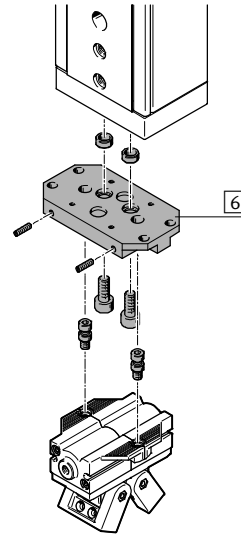

Accessories			
Type	Description	→ Page/Internet	
1 Centring sleeve ZBH	<ul style="list-style-type: none"> <li>For centring when attaching gripper fingers</li> <li>4 included in the scope of delivery of the gripper</li> </ul>	11	
2 One-way flow control valve GRLA	For regulating speed	grla	
3 Push-in fitting QS	For connecting compressed air tubing with standard O.D.	qs	
4 Proximity sensor SME/SMT-10	For sensing the piston position	11	
5 Centring sleeve ZBH	<ul style="list-style-type: none"> <li>For centring when attaching to a drive or plate</li> <li>2 included in the scope of delivery of the gripper</li> </ul>	11	
6 Adapter kit HAPG	Drive/gripper connections	adapter kit	

### Type codes

		HGRC	–	12	–	A
<b>Type</b>						
HGRC	Radial gripper					
<b>Size</b>						
<b>Position sensing</b>						
A	Via proximity sensor					

- 1 - Type discontinued  
Available up until 2018

## Radial grippers HGRC

Technical data

FESTO

Function  
Double-acting  
HGRC-...-A

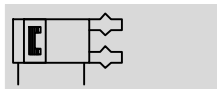

-  - Size  
12, 16, 20 mm
-  - Opening angle  
180°



General technical data				
Size	12	16	20	
Design	Rack and pinion Force-guided motion sequence			
Mode of operation	Double-acting			
Gripper function	Radial			
Number of gripper jaws	2			
Max. opening angle	[°] 180			
Pneumatic connection	M5			
Repetition accuracy <sup>1)</sup>	[mm]	≤ 0.05		
Max. interchangeability	[mm]	≤ 0.2		
Max. gripper jaw backlash <sup>2)</sup>	[mm]	≤ 0.1		
Max. gripper jaw angular backlash <sup>3)</sup>	[°]	≤ 0.5		
Max. operating frequency	[Hz]	≤ 4		
Rotational symmetry	[mm]	≤ ∅ 0.2		
Position sensing	Via proximity sensor			
Type of mounting	Via female thread and centring sleeve			
Mounting position	Any			
Product weight	[g]	200	350	700

1) End-position drift under constant operating conditions with 100 consecutive strokes in the direction of movement of the gripper jaws

2) Perpendicular to the direction of motion of the gripper jaws

3) Pretensioned, backlash-free ball bearing guide

Operating and environmental conditions		
Operating pressure	[bar]	2 ... 8
Operating medium	Compressed air in accordance with ISO 8573-1:2010 [7:4:4]	
Note on operating/pilot medium	Operation with lubricated medium possible (in which case lubricated operation will always be required)	
Ambient temperature <sup>1)</sup>	[°C]	+5 ... +60
Corrosion resistance class CRC <sup>2)</sup>	2	

1) Note operating range of proximity sensors

2) Corrosion resistance class 2 according to Festo standard 940 070

Components subject to moderate corrosion stress. Externally visible parts with primarily decorative surface requirements which are in direct contact with a normal industrial environment or media such as coolants or lubricating agents

## Radial grippers HGRC

Technical data

### Materials

Sectional view

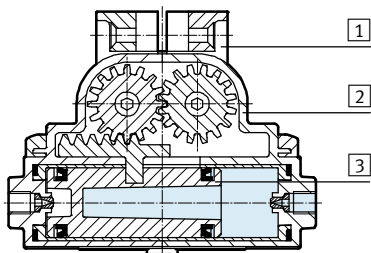

### Radial gripper

1	Gripper jaw	Die-cast zinc, painted
2	Housing	Die-cast zinc, painted
3	Piston	Polyamide
-	Seals	Polyurethane, nitrile rubber
-	Note on materials	Free of copper, PTFE and silicone
		RoHS-compliant

### Total gripping torque at 6 bar

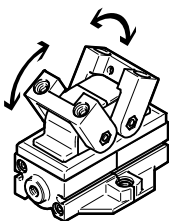

Size		12	16	20
Opening	[Ncm]	22	72	144
Closing	[Ncm]	22	72	144

### Static characteristic load values at the gripper jaws

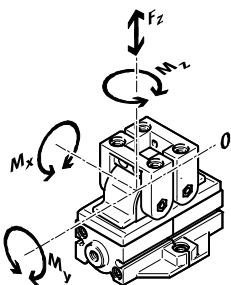

The indicated permissible forces and torques apply to a single gripper jaw. The indicated values include the lever arm, additional applied loads caused by the workpiece or external gripper

fingers, as well as forces which occur during movement.

The zero co-ordinate line (gripper jaw guide) must be taken into consideration for the calculation of torques.

Size		12	16	20
Max. permissible force $F_z$	[N]	40	60	80
Max. permissible torque $M_x$	[Nm]	2.5	4	8
Max. permissible torque $M_y$	[Nm]	0.6	1	1.9
Max. permissible torque $M_z$	[Nm]	2	3.2	6.7

- 1 - Type discontinued  
Available up until 2018

## Radial grippers HGRC

Technical data

FESTO

### Mass moment of inertia

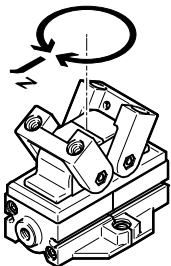

Mass moment of inertia [ $\text{kgm}^2 \times 10^{-4}$ ] of the radial gripper in relation to the central axis with no load.

Size	12	16	20
HGRC-...-A	[ $\text{kgm}^2 \times 10^{-4}$ ] 0.52	1.35	4.31

### Opening and closing times [ms] at 6 bar

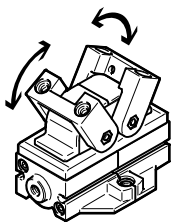

The indicated opening and closing times [ms] have been measured at room temperature and an operating pressure of 6 bar with vertically mounted gripper and without additional gripper fingers.

The grippers must be throttled for greater applied loads. Opening and closing times must then be adjusted accordingly.

Size	12	16	20	
Without external gripper fingers				
HGRC-...-A	Opening	120	160	170
	Closing	100	150	160

## Radial grippers HGRC

Technical data

### Gripping force $F_{Grip}$ per gripper jaw as a function of operating pressure and lever arm $x$

Gripping forces as a function of the operating pressure and the lever arm can be determined for the size using the following graph.

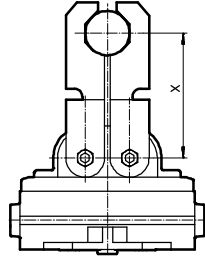

HGRC-12-A

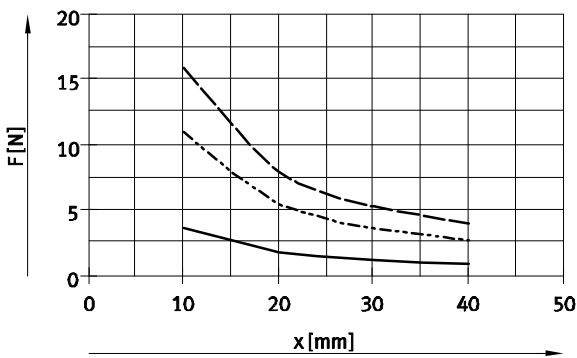

HGRC-16-A

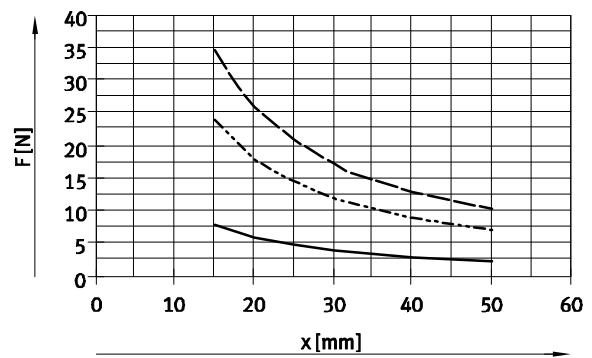

HGRC-20-A

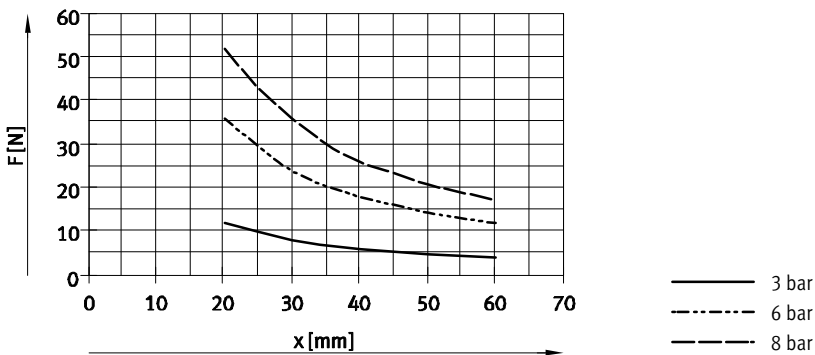

— 3 bar  
- - - 6 bar  
- · - 8 bar

- 1 - Type discontinued  
Available up until 2018

## Radial grippers HGRC

Technical data

FESTO

### Dimensions

Download CAD data → [www.festo.com](http://www.festo.com)

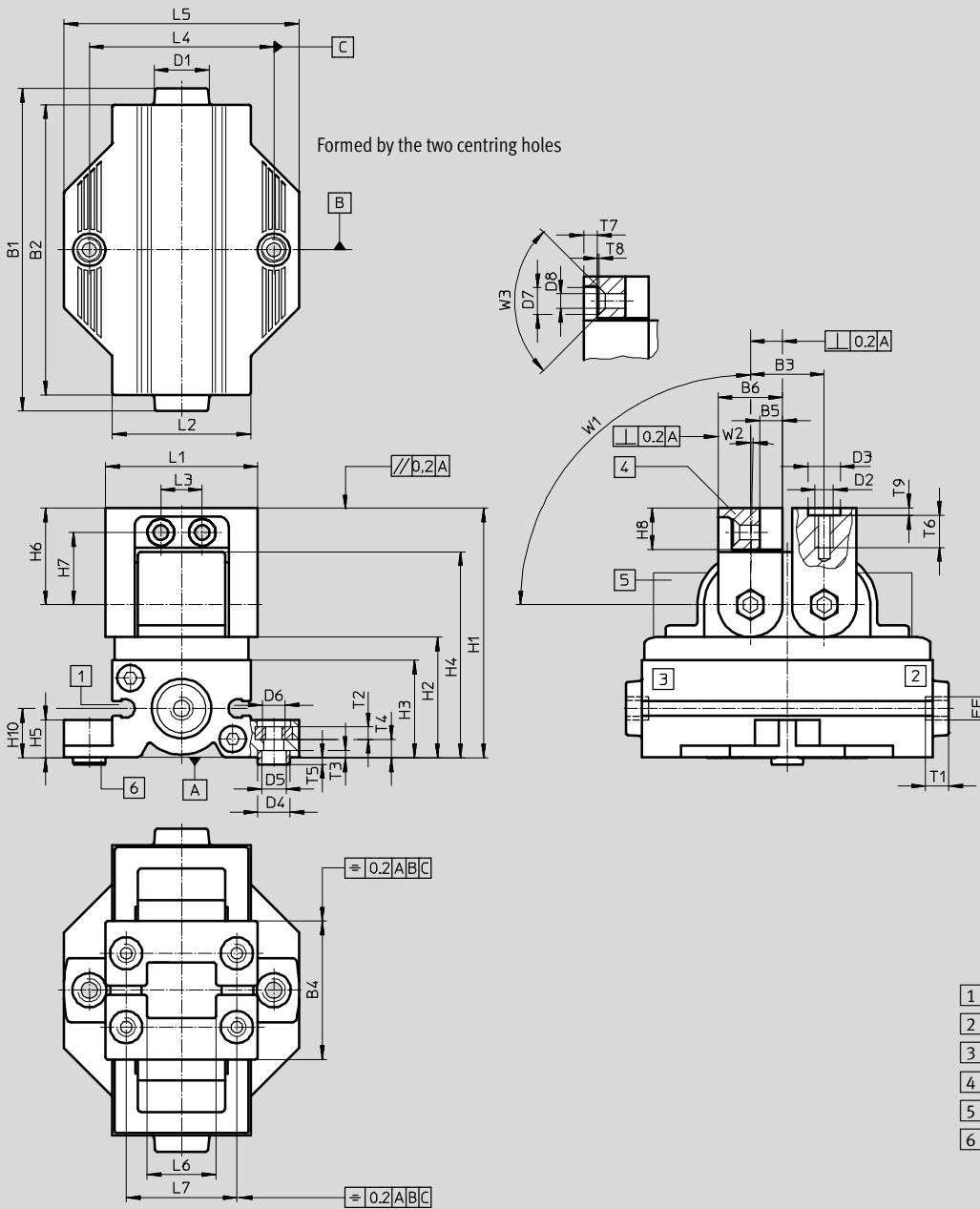



- 2 - Type discontinued  
Available up until 2018

FESTO

## Radial grippers HGRC

Technical data

Type	B1	B2	B3 ±0.05	B4 +0.25 -0.05	B5 +0.5	B6 +0.1	D1	D2	D3 +0.05 -0.02	D4 F10/h7	D5
HGRC-12	57	52	12	23	4	11	12	M3	5	7	5.3
HGRC-16	70	63	16	30	5.5	14	12	M4	7	7	5.3
HGRC-20	86	79	20	38	6	18	12	M5	9	9	6.4

Type	D6	D7	D8	EE	H1 ±0.5	H2	H3	H4	H5	H6 ±0.2	H7
HGRC-12	M4	4.8	2.6	M5	43.2	20.7	18.2	35.2	6.9	17	12.5
HGRC-16	M5	5.8	3.2	M5	54.2	26.2	21.2	44.7	8.2	21	15.7
HGRC-20	M6	8.1	4.4	M5	68.2	32.7	27	55.7	10.2	26.5	19.5

Type	H8	H10	L1 ±0.2	L2	L3 ±0.1	L4 <sup>1)</sup>	L5	L6 +0.25 -0.05	L7 <sup>1)</sup>	T1 min.
HGRC-12	7.5	9.2	27.5	25.5	6	33	42	12	20	4.5
HGRC-16	9	10.7	33	30	9	40	51	15	24	5
HGRC-20	12	13.7	45	38	12	50	65	21	33	5

Type	T2	T3 ±0.1	T4 +0.4 -0.3	T5 +0.1 -0.3	T6 min.	T7 +0.2	T8	T9 +0.1	W1 ±2	W2 ±3	W3
HGRC-12	2.2	1.7	3.1	1.3	6	1.7	0.5	1.3	90°	1°	90°
HGRC-16	2.7	1.8	3.8	1.2	7	3	0.3	1.6	90°	1°	90°
HGRC-20	3.2	2.3	5.2	1.7	9	3.5	0.5	2.1	90°	1°	90°

1) Tolerance for centring hole ±0.03  
Tolerance for thread ±0.2

### Ordering data

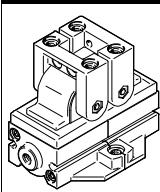
	Size [mm]	Double-acting	
		Part No.	Type
	12	<b>565129</b>	<b>HGRC-12-A</b>
	16	<b>565131</b>	<b>HGRC-16-A</b>
	20	<b>565133</b>	<b>HGRC-20-A</b>

- 7 - Type discontinued  
Available up until 2018

## Radial grippers HGRC

Accessories

FESTO



### Adapter kit HAPG

Material:  
Wrought aluminium alloy  
Free of copper and PTFE  
RoHS-compliant



Note

The kit includes the individual mounting interface as well as the necessary mounting material.

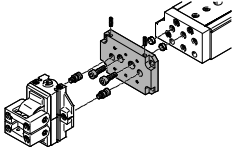
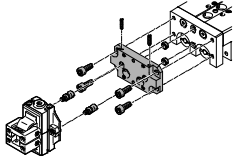
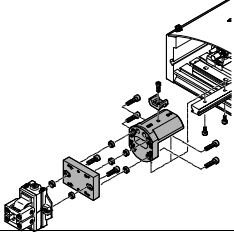
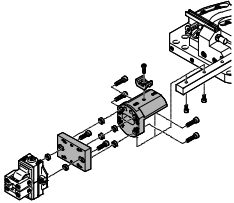
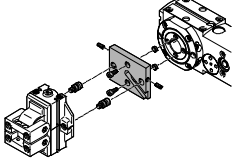
Permissible drive/gripper combinations with adapter kit							Download CAD data → <a href="http://www.festo.com">www.festo.com</a>	
Combination	Drive Size	Gripper Size	Mounting option		Adapter kit			
					CRC <sup>1)</sup>	Part No.	Type	
	DGSL	HGRC			HAPG			
	12, 16	12	■	■	2	529018	HAPG-58	
	20, 25	16	■	■		191267	HAPG-49	
	20, 25	20	■	■		191269	HAPG-51	
	SLT	HGRC			HAPG			
	10	12	-	■	2	542670	HAPG-100	
	16	12	-	■		529018	HAPG-58	
	16	16	-	■		542666	HAPG-101	
	20	16	-	■		191267	HAPG-49	
	20	20	-	■		542667	HAPG-102	
	25	20	-	■		191269	HAPG-51	
	HSP	HGRC				HAPG		
	16	16	-	■	2	191901	HAPG-55	
	25	20	-	■		540882	HAPG-71-B	
						191901	HAPG-55	
540883						HAPG-72-B		
	HSW	HGRC			HAPG			
	12	16	-	■	2	191901	HAPG-55	
	16	16	-	■		540882	HAPG-71-B	
						191901	HAPG-55	
540882						HAPG-71-B		
	ERMB	HGRC			HAPG			
	20	16	■	■	2	542668	HAPG-SD2-42	
	20	20	■	■		542669	HAPG-SD2-43	
	25	20	■	■		542758	HAPG-SD2-44	

1) Corrosion resistance class 2 according to Festo standard 940 070

Components subject to moderate corrosion stress. Externally visible parts with primarily decorative surface requirements which are in direct contact with a normal industrial environment or media such as coolants or lubricating agents.

 Type discontinued  
Available up until 2018

FESTO

## Radial grippers HGRC

Accessories

Ordering data – Centring sleeves			Technical data → Internet: zbh	
For size [mm]	Part No.	Type	PU <sup>1)</sup>	
For attachment to a drive or on a plate				
12, 16	186717	ZBH-7	10	
20	150927	ZBH-9	10	
For attaching gripper fingers				
12	189652	ZBH-5	10	
16	186717	ZBH-7	10	
20	150927	ZBH-9	10	

1) Packaging unit

Ordering data – Proximity sensors for C-slot					
Type of mounting	Electrical connection, connection direction	Switching output	Cable length [m]	Part No.	Type
N/O contact, magneto-resistive <span style="float: right;">Technical data → Internet: smt</span>					
Insertable in slot from above	Cable, 3-wire, in-line	PNP	2.5	551373	SMT-10M-PS-24V-E-2,5-L-OE
	Plug M8x1, 3-pin, in-line		0.3	551375	SMT-10M-PS-24V-E-0,3-L-M8D
N/O contact, magnetic reed <span style="float: right;">Technical data → Internet: sme</span>					
Insertable in slot length-wise	Cable, 3-wire, in-line	Contacting	2.5	173210	SME-10-KL-LED-24
	Plug M8x1, 3-pin, in-line		0.3	173212	SME-10-SL-LED-24

Ordering data – Proximity sensors for C-slot					
Type of mounting	Electrical connection, connection direction	Switching output	Cable length [m]	Part No.	Type
N/O contact, magneto-resistive <span style="float: right;">Technical data → Internet: smt</span>					
Insertable in slot from above	Cable, 3-wire, lateral	PNP	2.5	551374	SMT-10M-PS-24V-E-2,5-Q-OE
	Plug M8x1, 3-pin, lateral		0.3	551376	SMT-10M-PS-24V-E-0,3-Q-M8D
N/O contact, magnetic reed <span style="float: right;">Technical data → Internet: sme</span>					
Insertable in slot length-wise	Cable, 3-wire, lateral	Contacting	2.5	173211	SME-10-KQ-LED-24
	Plug M8x1, 3-pin, lateral		0.3	173213	SME-10-SQ-LED-24

Ordering data – Proximity sensors for C-slot					
Type of mounting	Electrical connection, connection direction	Switching output	Cable length [m]	Part No.	Type
N/O contact, magneto-resistive <span style="float: right;">Technical data → Internet: smt</span>					
Insertable in slot length-wise	Cable, 3-wire, lateral	PNP	2.5	547862	SMT-10G-PS-24V-E-2,5Q-OE
	Plug M8x1, 3-pin, lateral		0.3	547863	SMT-10G-PS-24V-E-0,3Q-M8D

Ordering data – Connecting cables					Technical data → Internet: nebu
Electrical connection, left	Electrical connection, right	Cable length [m]	Part No.	Type	
Straight socket, M8x1, 3-pin	Cable, open end, 3-wire	2.5	541333	NEBU-M8G3-K-2.5-LE3	
		5	541334	NEBU-M8G3-K-5-LE3	
Angled socket, M8x1, 3-pin	Cable, open end, 3-wire	2.5	541338	NEBU-M8W3-K-2.5-LE3	
		5	541341	NEBU-M8W3-K-5-LE3	